

Parts list for the **SOLVENTS 10/20/30** Compression Sprayer

CROPLANDS

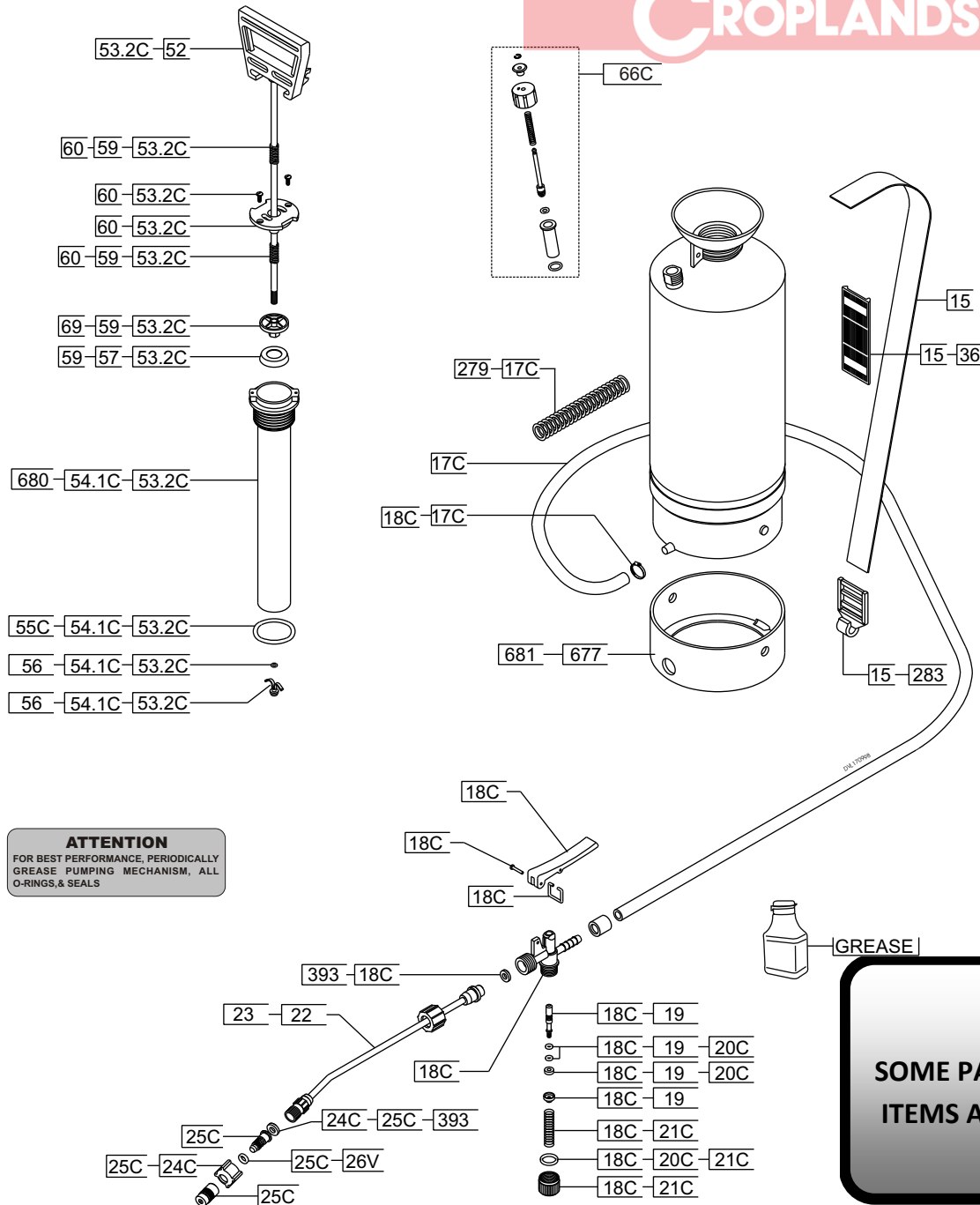

ATTENTION

FOR BEST PERFORMANCE, PERIODICALLY
GREASE PUMPING MECHANISM, ALL
O-RINGS, & SEALS

SWISSMEX[®]
SOLVENTS 10

SWISSMEX[®]
SOLVENTS 20

SWISSMEX[®]
SOLVENTS 30

PARTS LIST

Kit 15	Shoulder strap, pad, buckle & clip (1each).
Kit 17C	Hose set with 2 hose clamps & protective spring.
Kit 18C	Complete spray gun with seals.
Kit 19	Spindle set.
Kit 20C	Spindle O-ring set.
Kit 21C	Plug set.
Kit 22	20" Brass spray wand.
Kit 24C	Nozzle holder.
Kit 25C	Adjustable brass nozzle with nozzle holder.
Kit 26V	Viton O-ring for spray tip.
Kit 36	Shoulder pads for use with shoulder strap.
Kit 52	Pump handle.
Kit 53.2C	Complete pump module.
Kit 54.1C	Pump tube with large thread for construction units.
Kit 55C	Large O-ring.
Kit 56	Check valve antenna & O-ring.
Kit 57	Pump plunger.
Kit 59	Pump plunger assembly set.
Kit 60	Screw set for top of pump.
Kit 66C	Pressure relief valve.
Kit 69	Piston seat.
Kit 279	Protective hose spring.
Kit 283	Shoulder strap clips.
Kit 393	Washer set for construction spray gun (Kit 18FC).
Kit 677	Gray tank base.
Kit 680	Pump tube.
Kit 681	Gray tank base.
+ Kit GREASE	Silicone grease lubricant for all sprayers.

NOTE: + Not supplied with unit see sheet of accessories.

NOTE

SOME PARTS ARE NON-STOCK
ITEMS AND MAY NEED TO BE
ORDERED

NOTE

PLEASE ADD PREFIX **SW** TO
PART NUMBER TO REFLECT
CROPLANDS PART NUMBER

The SOLVENTS 10/20/30 Compression Sprayers

We would like to congratulate you on the purchase of your new **SOLVENTS 10/20/30**. The sprayer that allows you the most comfortable way of carry out spraying projects. You are the owner of the easiest most reliable units made today. These units are designed to spray for over 10 minutes with only two sessions of 40 pump strokes.

- We strongly recommend you to carefully read and follow all the information on this sheet, the Warnings Sheet and the Trouble Shooting Guide (if needed). Also follow all instructions and MSDS (Material Safety Data Sheet) provided by the manufacturer of the chemical product used.

ASSEMBLY INSTRUCTION

1. Attach spray wand to spray gun and tighten firmly.
2. If unit is fitted with pressure valve, secure tightly.

HOW TO PREPARE YOUR SOLVENTS 10/20/30 FOR USE

1. Before you remove pump, be sure there is no pressure in the tank. In order to release pressure, invert unit upside down and squeeze spray pistol (aim away from you). Pressure will escape; when hissing stops, all pressure has been released. Remove pump assembly by turning counter-clockwise. The pump handle has two locking positions, one turning clockwise and one counter-clockwise.
2. Mix solution in a separate receptacle, following manufacturer's directions on the container.
3. Pour pre-mixed solution into sprayer; then put pump assembly back into sprayer and tighten down firmly. You are now ready to pressurize the sprayer.
4. The following chart will provide you with a guide for operating pressures. Approximate working pressures:

1 gallon unit.

40 full strokes +/- 42 psi

2 gallon unit.

35 full strokes +/- 35 psi

3 gallon unit.

35 full strokes +/- 35 psi

5. The pressure relief valve will release at 42 psi.
6. Spray pistol may be locked in the open position for continual spraying.

HOW TO ADJUST THE SOLVENTS 10/20/30 NOZZLE

1. To adjust nozzle, tighten cap (turn clockwise) for fine atomized spray, or loosen (turn counter-clockwise) for coarser spray or solid stream.

EMPTYING TANK

1. Be sure there is no pressure in the tank (see How to Prepare your Solvents 10/20/30 for Use, #1).

HOW TO CLEAN AND MAINTAIN YOUR SOLVENTS 10/20/30.

1. Release pressure as previously indicated.
2. Remove pump module and pour out remaining solution; then rinse all parts thoroughly with clean water.
3. Leaving approximately ½ gallon of fresh water in tank, pressurize and flush the hose and wand by depressing trigger to clean out system; then drain all remaining water.
4. Always store tank clean and empty, and in a dry and shaded location.

PUMP MAINTENANCE

1. Pump seals should be lubricated periodically to insure proper lubrication and seal life.
2. If pumping does not pressurize the tank, remove pump from tank; then remove the two screws from top of pump module. Pull plunger out and inspect seals. If damaged, obtain original **SWISSMEX** replacement parts from your dealer and replace.
3. Oil new seals and insert back into pump module. Tighten both screw. You are now ready to use your sprayer.